

500Vac/dc, 6x32mm, High Inrush Withstand  
HV681.XX H-BT Series



**Description**

- High inrush withstand capability, high breaking capacity under 500VAC/DC
- Special Engineering Material tube
- High breaking capacity for high energy application
- Design refer to ISO8820-8/JASO D622
- RoHS and Lead Free material

Electrical Characteristics	
1.0In	4 hours, Minimum
2.0In	0.5 - 100sec.
3.0In	0.1 - 10sec.
5.0In	0.05 - 1.0sec.

**Application**

- AC/DC module for EV/HEV charging
- PDU for EV/HEV
- DC/DC module for EV/HEV/ESS

**Specifications**

Part No.	Rated Voltage	Rated Current	Breaking Capacity (A)	Typical Cold Resistance (mOhms)	Typical Pre-Arcing I <sup>2</sup> t (A <sup>2</sup> Sec)
HV681.16 H-BT	500VAC/DC	16A	20000	5.8	395
HV681.20 H-BT		20A		4.0	620
HV681.25 H-BT		25A		3.3	965
HV681.30 H-BT		30A		2.6	1700

\* DC Cold Resistance are measured at <10% of rated current in ambient temperature of 25°C

\* Typical Pre-arcing I<sup>2</sup>t are measured at 10In Current

**Dimension (mm)**

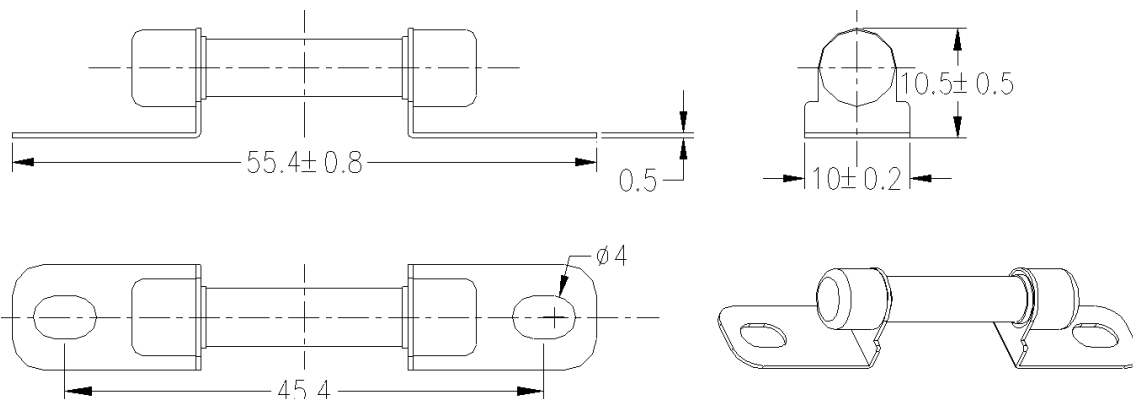

Recommend Bolt Center Range: 43.8 – 47.0mm

Recommend Tightening Torque: 1.5 - 2.5Nm

500Vac/dc, 6x32mm, High Inrush Withstand  
HV681.XX H-BT Series



Time-Current Curve 时间电流曲线

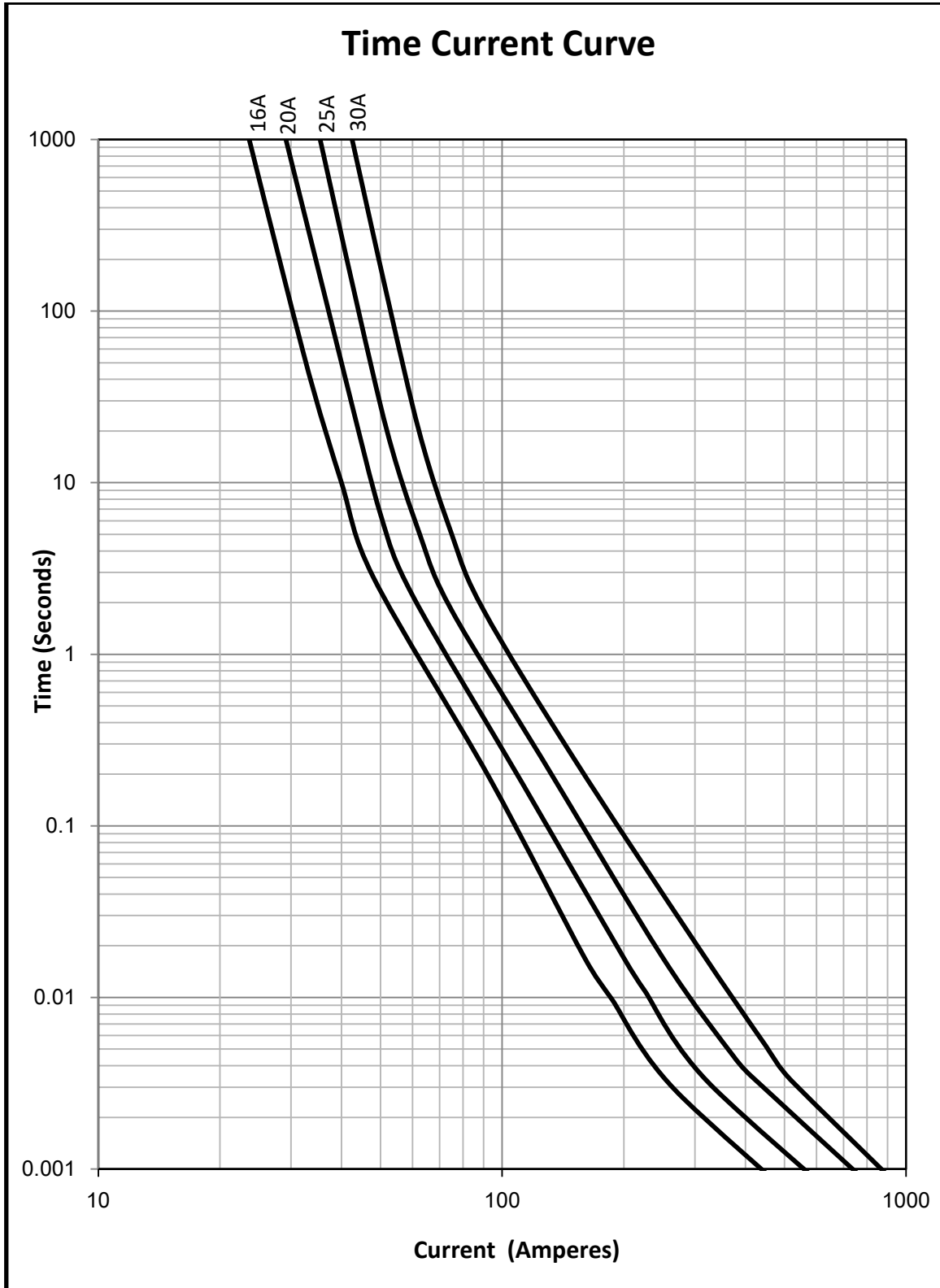

500Vac/dc, 6x32mm, High Inrush Withstand  
HV681.XX H-BT Series



**Transportation and Storage 运输与储存**

During transportation and storage, should avoid water seepage and mechanical damage 运输与储存期间,应避免雨雪侵蚀和机械损伤.

**Conditions for operation in service 工作条件**

Where the following conditions apply, fuses complying with this standard are deemed capable of operating satisfactorily without further qualification.

- Normal temperature: -5°C to 40°C;
- The altitude of the site of installation of the fuses does not exceed 2 000 m above sea level;
- The air is clean and its relative humidity does not exceed 50% at the maximum temperature of 40°C;
- Higher relative humidities are permitted at lower temperatures, e.g. 90 % at 20°C;
- Under these conditions, moderate condensation may occasionally occur due to variation in temperature.

For operation condition **other than** above, please contact manufacturer.

在以下条件下使用,熔断器认为能正常工作,不需要进一步验证:

- 周围空气温度:-5°C to 40°C;
- 安装地点的海拔不超过2000米;
- 空气是干净的,其相对湿度在最高温度为40°C时不超过50%;
- 在较低温度下可以有较高的相对湿度,例如,在20°C时,相对湿度可达90%;
- 在这些条件下,由于温度变化,可能偶然发生中等凝露.

如果使用条件**超出**以上范围,请咨询制造商以确认相应的折减计算.

**Vibration震动条件**

Meet JASO D622:2006 Section 6.3.3 Vibration durability test requirement, can be use on Electrical Vehicle application;

符合JASO D622:2006章节6.3.3的震动测试要求,可用于一般电动汽车应用.

**Temperature Rerating Curve 温度调额曲线**

Operating Temperature: -40°C to +125°C, with proper rerating factor applied

