

## 1500Vdc, Photovoltaic Fuses AC10XLgPV Series



### Description

- 1500Vdc Fuse for Solar Applications
- Designed to UL 248-19(2579)
- Capable of withstanding high cycling and low level fault current conditions

### Specifications

Part No./Rating	Rated Voltage DC	Rated Current	Breaking Capacity	Energy Integrals $I^2t$ (A <sup>2</sup> S)		Power Loss (W)		
				Pre-Arcing at 1500V/30kA	Total at 1500V/30kA	0.7In	0.8In	1.0In
AC10XLgPV2	1500V	2A	30kA	3.5	10	1.1	1.45	2.6
AC10XLgPV4		4A		15	50	1.2	1.55	2.8
AC10XLgPV5		5A		22	75	1.4	1.8	3.2
AC10XLgPV10		10A		300	1100	1.7	2.3	4.2
AC10XLgPV12		12A		20	60	1.8	2.4	4.2
AC10XLgPV15		15A		35	95	2	2.8	5

### Dimension (unit: mm)

Standard cylindrical (ordering code: AC10XLgPVxx)

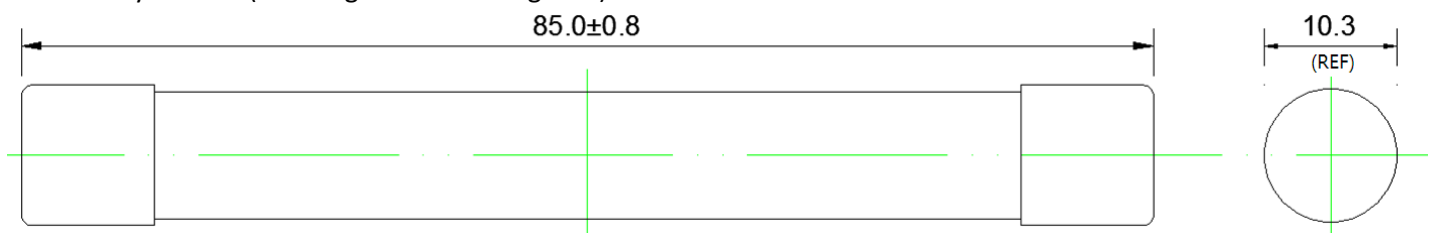

In-line with crimp terminals, wire range 10-12 AWG (ordering code: AC10XLgPVxx-l):

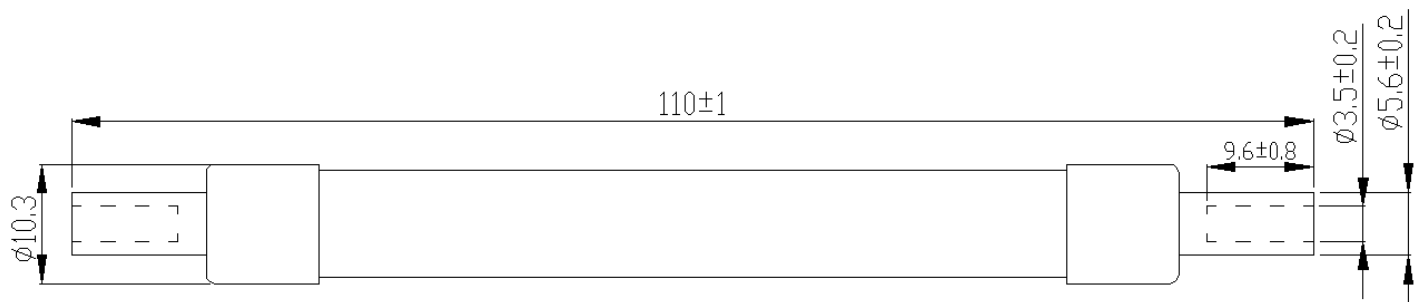

Note: for 10-12AWG (6-4mm<sup>2</sup>); Recommended Crimping Tool: T&B Sta-Kon ERG4002 or equivalent

1500Vdc, Photovoltaic Fuses  
AC10XLgPV Series



Time Current Curve

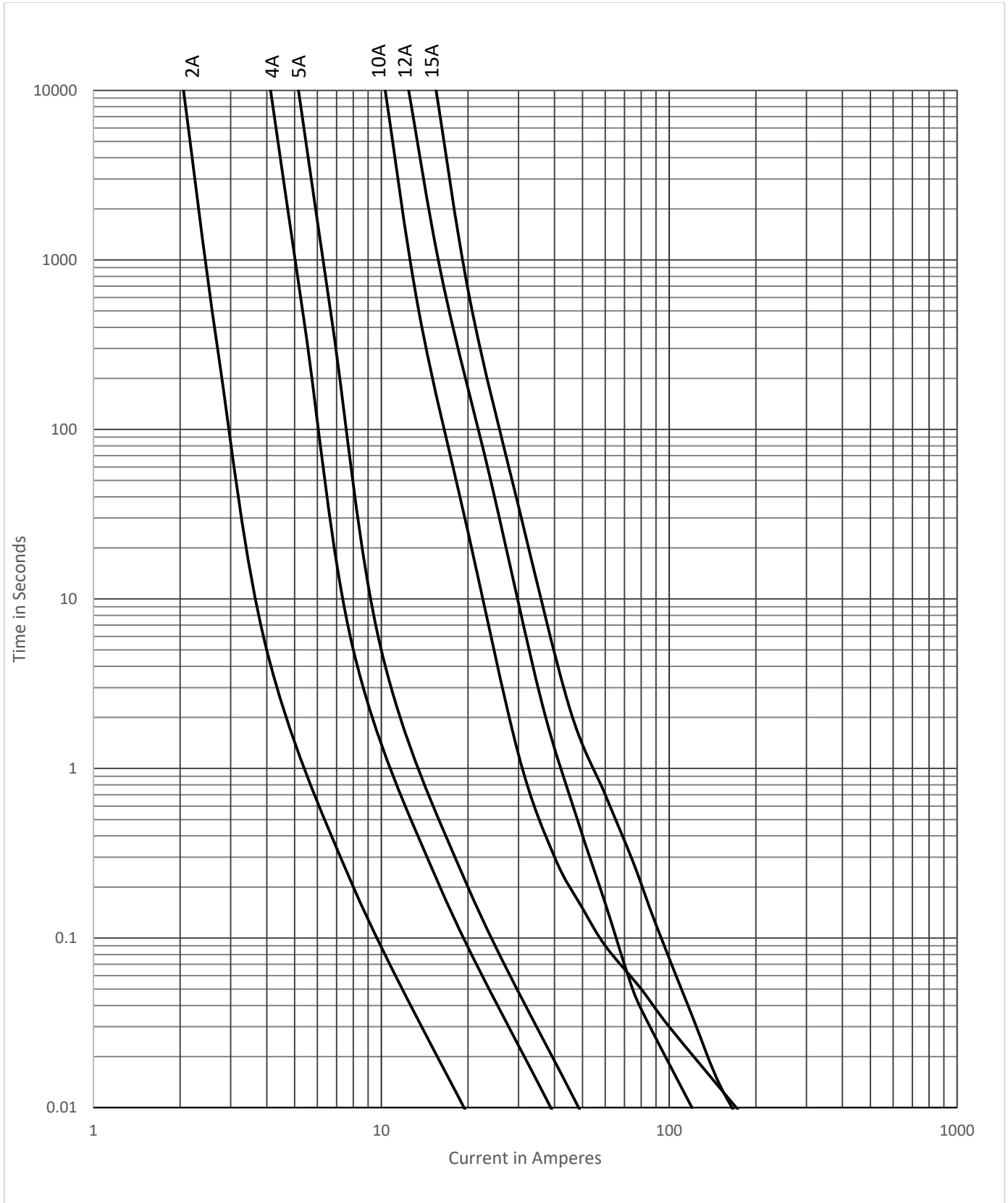

1500Vdc, Photovoltaic Fuses  
AC10XLgPV Series



Temperature Re-Rating Curve

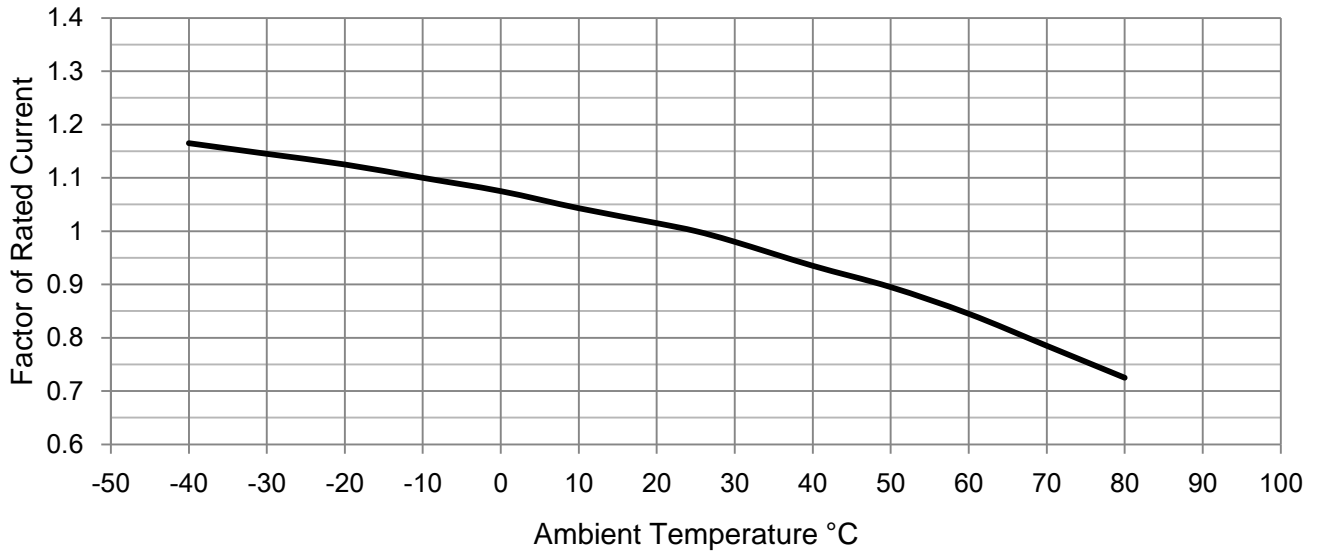

Package/MOQ

AC10XLgPVxx: 28pcs fuses in one carton;  
AC10XLgPVxx-l: 40pcs fuses in one carton.